

# Quick Set-up Guide

## Snow Melting Control PM-653

### 1. Location

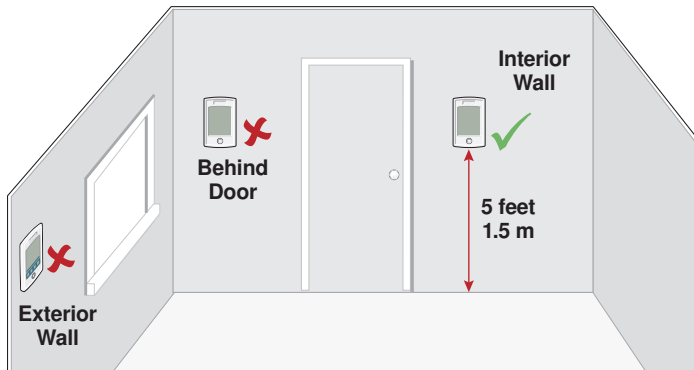

### 2. Remove Mounting Base

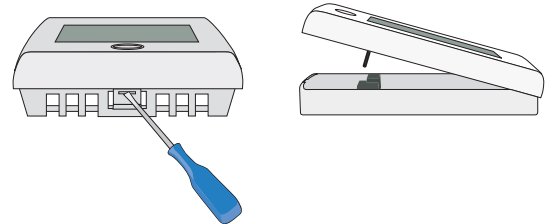

### 3. Install Mounting Base

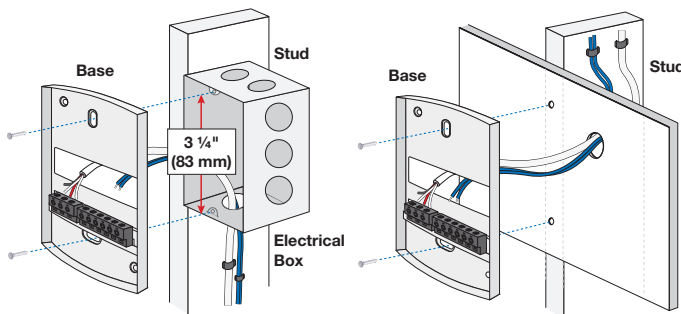

### 4. Switch Settings

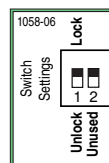

Back of Control

#### LOCK ACCESS LEVEL

The control is locked and the access level cannot be changed. Set to Lock when installation has been completed.

#### UNLOCK ACCESS LEVEL

The control is unlocked and the access level may be changed. Go to the Toolbox menu to change the access level. Set to Unlock during the installation process.

### 5. Wiring

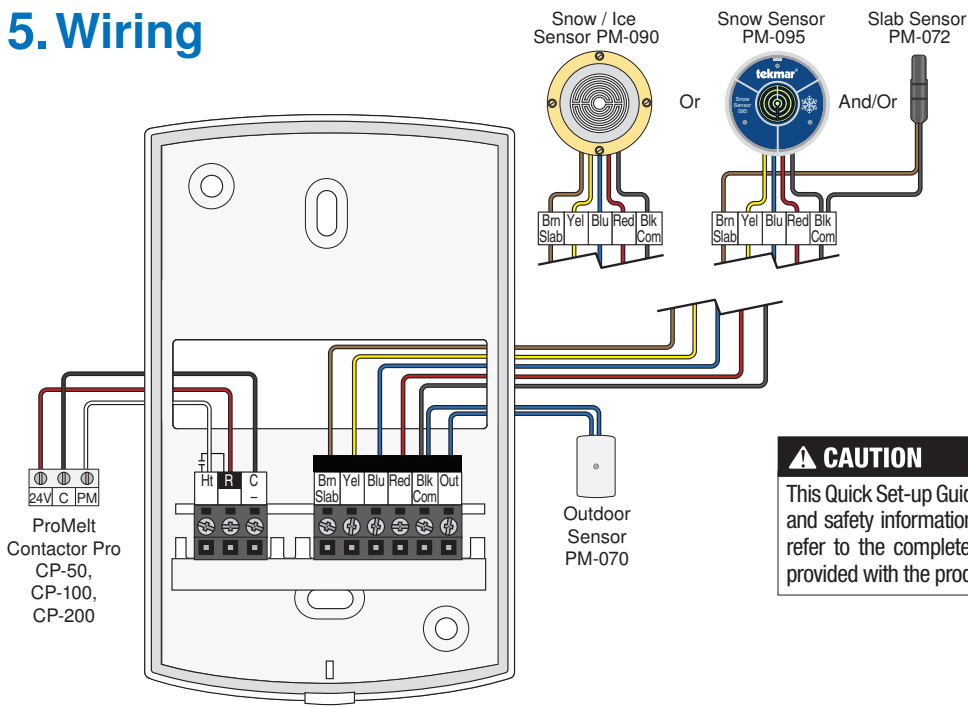

#### CAUTION

This Quick Set-up Guide is not intended to provide full installation instructions and safety information. In order to avoid property damage or injury, please refer to the complete installation manual and product safety information provided with the product.

## 6. Install the Control

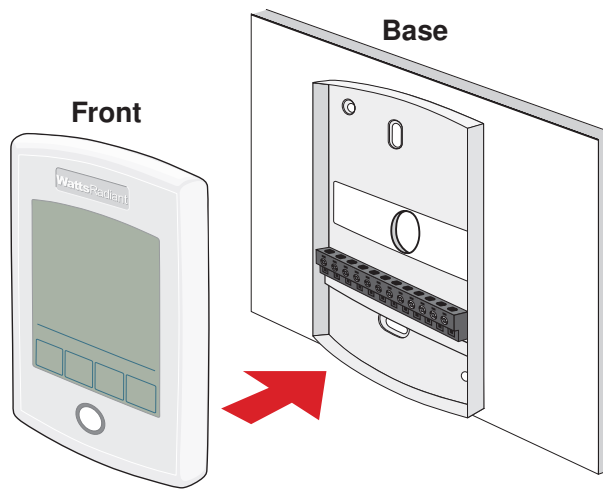

## 7. User Interface

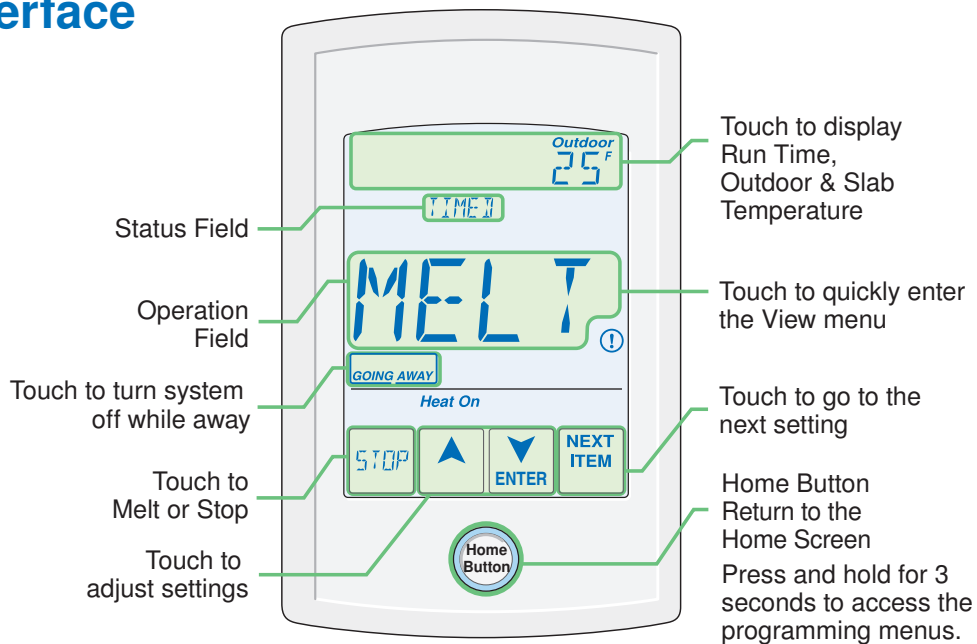

## 8. Critical Settings

The System Menu provides settings on how to configure and operate the mechanical equipment.

Item Field	Description
<b>SNOW/ICE</b> SENSOR	<b>SNOW / ICE SENSOR</b> Select if a Snow / Ice Sensor PM-090, or Snow Sensor PM-095 is installed. Default = 090
<b>SLAB</b> SENSOR	<b>SLAB SENSOR</b> Select if a Slab Sensor PM-072 is installed to measure the slab temperature. Default = ON
<b>MAX MELT</b> DAYS	<b>MAXIMUM MELT TIME</b> Select to limit the amount of melting run time. Default = 3.0 days



A Watts Water Technologies Company

USA: Tel: (888) 432-8932 • Fax: (417) 831-4067

Canada: Tel: (888) 208-8927 • Fax: (905) 332-7068

Latin America: Tel: (52) 81-1001-8600 • Fax: (52) 81-8000-7091